

- Note:
- All elevations are in metres above Ordnance Datum.
  - For Key Plan refer to drawing PRN-ARP-CH-010.
  - For sections locations refer to drawing PRN-ARP-CH-014.
- Key:
- Existing ground
  - Bottom of topsoil
  - Proposed ground

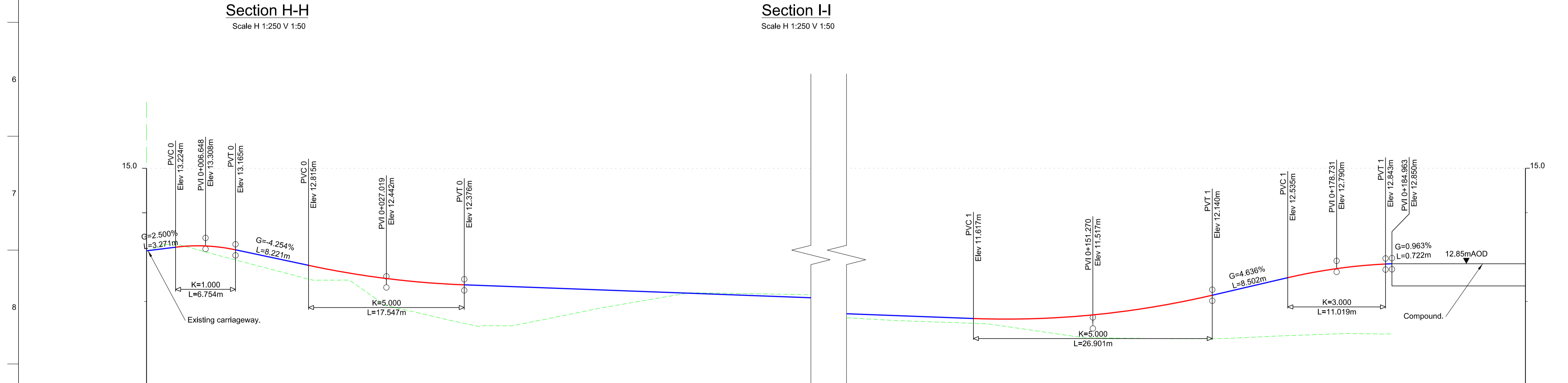

Chainage	Existing Level	Proposed Level
0+000.000	12.142	12.142
0+002.500	13.281	13.205
0+005.000	13.206	13.252
0+007.500	13.070	13.240
0+010.000	12.957	13.166
0+012.500	12.806	13.059
0+015.000	12.676	12.953
0+017.500	12.545	12.847
0+020.000	12.481	12.743
0+022.500	12.462	12.652
0+025.000	12.181	12.573
0+027.500	11.884	12.507
0+030.000	11.774	12.463
0+032.500	11.657	12.412
0+035.000	11.543	12.383
0+037.500	11.435	12.364
0+040.000	11.454	12.345
0+042.500	11.506	12.326
0+045.000	11.606	12.308
0+047.500	11.707	12.289
0+050.000	11.807	12.271
0+052.500	11.901	12.252
0+055.000	11.987	12.233
0+057.500	12.072	12.215
0+060.000	12.157	12.196
0+062.500	12.193	12.178
0+065.000	12.195	12.159
0+067.500	12.178	12.140
0+070.000	12.170	12.122
0+072.500	12.162	12.103

02	18/07/16	SM	RB	RB
For Tender				
01	02/07/15	KK	RB	RB
For Information				
Issue	Date	By	Chkd	Appd

**ARUP**

Admiral House, Rose Wharf,  
79 East Street, Leeds, LS9 8EE  
Tel +44(0)113 242 8498 Fax +44(0)113 242 8573  
www.arup.com

Client  
**Cuadrilla Bowland Ltd**

Job Title  
**Shale Gas Exploration at Preston New Road**

**Access Road Cross Sections and Long Section**

Scale at A1 As Shown

Discipline Highways

Job No **230382-00** Drawing Status **For Approval**

Drawing No **PNR-ARP-CH-015** Issue **03**